



COALESCE Research Fund
Collaborative Alliances for Societal Challenges

GUIDE FOR APPLICANTS

PLEASE READ THIS DOCUMENT CAREFULLY BEFORE YOU REGISTER AS AN APPLICANT TO THE COMPETITION

2020



Rialtas na hÉireann
Government of Ireland



**An Roinn Breisoideachais agus Ardoideachais,
Taighde, Nuálaíochta agus Eolaíochta**
Department of Further and Higher Education,
Research, Innovation and Science



**An Roinn Gnóthaí
Eachtracha agus Trádála**
Department of
Foreign Affairs and Trade



**An Roinn Talmhaíochta,
Bia agus Mara**
Department of Agriculture,
Food and the Marine

1. Important deadlines for this call

Launch of Call	28 th October 2020
FAQ deadline	15 th December 2020
APPLICANT DEADLINE	22nd of December 2020 at 12:00 pm Irish Time
Research Office endorsement deadline	20 th January 2021
Outcome of scheme	May 2021
Commencement of projects	Q3 2021

Contents

1. Important deadlines for this call	2
2 Purpose of the Guide for Applicants	4
3 About the Irish Research Council	4
4 Context for the COALESCE Call	4
5 Eligibility check	5
5.1 COALESCE Research Funding Eligibility Flowchart	5
6 Using the OLS (Online System)	6
6.1 Registering as an applicant for the first time	7
6.2 Definition of ordinarily resident	9
6.3 Using the OLS to create an application	9
6.4 To log in	10
6.5 Creating a new Application	11
6.6 Editing a draft application	12
6.7 Personal Details	13
6.8 Managing your personal details	14
6.9 Completing the application	15
6.10 Completing the Overview Tab	15
6.11 Completing the Project Details Tab	16
6.12 Completing the Ethical Statement	18
6.13 Project Budget	19
6.14 Academic Qualifications	20
6.15 Ethical Table and Sex/Gender Statement	21
6.16 Applicant Declarations and Submission	22
7 Assessment Process	23
8 Notification and feedback	23
9 Information for successful award holders	23
9.1 Submission of Ethical Approval, a Data Management Plan and a Research Agreement	23
10 Guidance on the Sex/Gender Dimension Statement	24
10.1 A Summary from the 'Toolkit Gender in EU-funded research'	24
10.2 Checklist for Sex and/or Gender in Research content	25

2 Purpose of the Guide for Applicants

This guide provides practical information to potential applicants in preparing and submitting an application for the Irish Research Council Coalesce Research Fund. In addition, it provides a general overview of the Irish Research Council assessment process.

The Irish Research Council Coalesce Research Fund is governed by the particular Terms and Conditions underlying the award, and the Award Acceptance Form. The contents of this guide are for general information purposes and the assistance of applicants. In the event of any discrepancy arising between this guide and the Terms and Conditions/Acceptance Form, the latter will prevail.

Accordingly, applicants are strongly recommended to familiarise themselves FULLY with the Terms & Conditions, and also to read carefully any Frequently Asked Questions (FAQ) before completing and submitting applications.

The Council reserves the right to revise this Guide for Applicants.

3 About the Irish Research Council

The mission of the Irish Research Council is to support excellence in research talent, knowledge and engagement, including by responding to emerging research and societal challenges and proactively assisting stakeholders to address complex issues. The Council's Strategic Plan 2020-2024 seeks to position the Council as a partner of choice nationally and internationally to support excellent research that addresses the challenges of our time. It also emphasises the importance attached by the Council to facilitating the sharing of research and innovations to the maximum extent possible. Government and policy-makers, enterprise and civil society are all key stakeholders with whom strong relationships with researchers are key. The COALESCE programme (Collaborative Alliances for Societal Challenges) is a key driver supporting progress on the aforementioned strategic priorities and the third call under the programme is now being launched.

4 Context for the COALESCE Call

Ireland faces key social, environmental and economic challenges, the complexity and scale of which have been heightened by the COVID-19 pandemic. Including the global public health crisis, Ireland shares a diverse range of societal challenges with the global community, whilst also facing more particular but no less pressing challenges such as Brexit. The various challenges we share as nations are well-articulated, particularly in the form of the **2030 Agenda for Sustainable Development**, incorporating 17 goals. Horizon2020 integrated societal challenges as a key pillar of the framework, and FP9, Horizon Europe, will roll out next year using a mission-based framework.

Ireland has a cross-governmental challenge-based approach through the **National Planning Framework (Ireland 2040)** and the associated National Development Plan. The framework sets out 10 National Strategic Outcomes (NSOs, see Appendix 1, the achievements of which are necessary to ensure prosperity, equality, a sustainable future and protection of our natural environment. The impact of COVID-19 has driven a medium-term [National Economic Plan](#) to the top of the government's agenda, and this plan is currently in development. A sustainable, balanced and inclusive economic recovery, alongside pre-existing challenges such as Brexit, digitalisation and decarbonisation will be at the centre of the new plan. The approach to these challenges will include a new all-island focus with the government's **Shared Island** initiative.

The achievement of national or global goals will be challenging in themselves and will require an unprecedented level of collaboration and coordination both within the State and on an interjurisdictional basis. Given the myriad agencies that will be at the 'coal-face' in implementation of national plans, major opportunities for researchers to form new connections and links will emerge, regionally and locally, and in doing so will further demonstrate the value of the Irish research system as a national resource.

Excellent research across all disciplines has a major role to play in developing new knowledge and evidence, which policy and decision-makers and practitioners can utilise to guide action and interventions on the path to successfully achieving national or international societal challenges. Maximising the contribution of the research system in this regard requires a strong emphasis on building robust mechanisms to ensure the transmission and integration of knowledge and evidence into the policy and practice environment, including building the necessary relationships with the public sector, civil society, or elsewhere, to support this process.

The Call seeks to fund excellent research addressing national and European/global national challenges as set out in the challenge frameworks now in place. This year, the call features an open strand together with two strands run in partnership with government departments

5 Eligibility check

All applicants should check they are eligible to apply by carefully studying the 'COALESCE Eligibility Flowchart'.

5.1 COALESCE Research Funding Eligibility Flowchart

Do you currently an Irish Research Council Award?

Yes

– Please give details

No – an applicant is **eligible** to apply.

Are you an academic or researcher who, on the call deadline of 22 December 2020, holds a contract of sufficient duration with a Higher Education Institution or a recognised Research Performing Organisation (as defined in the 2020 Terms & Conditions) to carry out the proposed research from the project start date in Q3 2021 until the project end date?

Yes –An applicant is eligible to apply.

No –An applicant is **ineligible**.

Strand 1K & 2A: Is your PhD graduation date before 31st May 2019?

Yes –An applicant is eligible to apply.

No –An applicant is **ineligible**.

Strand 2B: Is your PhD graduation date before 31st May 2016?

Yes –An applicant is eligible to apply.

No –An applicant is **ineligible**.

Strand 1K Only: Are you an academic or researcher who has at least two years' experience as a PI, experience of collaboration with research consortia and/or national research development projects and who has a track record in the research area of the DAFM strand?

Yes -an applicant is eligible to apply.

No -an applicant is **ineligible**.

Strand 2A Only: Is the identified co-PI on strand 2A a STEM academic or researcher who, on the call deadline, holds a contract of sufficient duration with a Higher Education Institution or a recognised Research Performing Organisation (as defined in the 2020 Terms & Conditions) to carry out the proposed research from the project start, until the project end date?

Yes -an applicant is eligible to apply.

No -an applicant is **ineligible**.

Strand 2B Only: Are you an academic or researcher who has at least five years' experience as a PI, experience of collaboration with research consortia with an international focus and/or international research development projects and who has a track record in research under one or more of the DFA themes for this strand? Note: if the applicant is 3 years post-PhD and has won a New Foundations grant (DFA Strand), the applicant will be eligible. Applicants who are eligible under the latter caveat will need to demonstrate that they have the skills and experience to manage a project of this scale

Yes -an applicant is eligible to apply.

No -an applicant is **ineligible**.

Strand 2B Only: Is the co-PI an academic or researcher who has at least three years' experience as a PI, experience of collaboration with research consortia with an international development focus and/or international research development project/s and who has a track record in research under one or more of the DFA themes for this strand?

Yes -an applicant is eligible to apply.

No -an applicant is **ineligible**.

Strand 2A and 2B Only: Does any identified co-PI, academic or researcher, on the call deadline of 22 December 2020, hold a contract of sufficient duration with a Higher Education Institution or a recognised Research Performing Organisation (as defined in the 2020 Terms & Conditions) to carry out the proposed research from the project start date, until the project end date?

Yes -an applicant is eligible to apply.

No -an applicant is **ineligible**.

Have you informed the Research Office in the (proposed) host institution of your intention to submit an application to the COALESCE Programme?

Yes -an applicant is eligible to apply.

No -an applicant is **ineligible**.

6 Using the OLS (Online System)

6.1 Registering as an applicant for the first time

Before you start, please ensure you are using the correct browser. The OLS can only be guaranteed to be fully operational on the following browsers:

Internet Explorer: version 11.0 and higher

Firefox download: two most recent versions*

Google Chrome download: two most recent versions*

Safari download: two most recent versions*

*Firefox, Google Chrome and Safari support applies to the two most recent versions published by the manufacturer excluding beta releases. Also, please ensure your JavaScript is both turned on and up to date.

Internet Explorer **Compatibility Mode should **NOT** be enabled for access to SmartSimple, as some items such as icons displayed on buttons (Font Awesome) and other aspects of the system will not render correctly.

Next, add the ircapps@research.ie email address to your contacts/address book BEFORE you attempt the registration process.

Use the following link to take you to the '**Applicant registration page**'
https://irishresearch.smartsimple.ie/s_signup.jsp?token=XVtQC1oGYFpfRxNZXxVSSIbSZg%3D%3D
Please fill in the form as prompted.



IRISH RESEARCH COUNCIL
An Chomhairle um Thaighde in Éirinn

Applicant registration page

This is the first step of the application process. After you have completed and submitted this form you will receive an e-mail with a username and password which will enable you to access your Irish Research Council profile and start your application. If you have previously registered with this system there is no need to register again: You can login to your account at any time at the following address irishresearch.smartsimple.ie

* Prefix:

* Gender:

* Date of Birth (dd/mm/yyyy):

* First Name:

* Last Name:

* Email:

* Confirm Email:

* Phone:

* Address:

* City:

Post Code:

* Country:

* Country of Citizenship:

* Area where you are ordinarily resident (EU/ Non EU):

Submit

6.2 Definition of ordinarily resident

The last field, 'Area where you are ordinarily resident (EU/Non-EU)' seeks to determine your EU status based on the country within which you have been resident for the last number of years.

Applicants deemed to be citizens of the EU are those applicants who are either citizens of Ireland or of a Member State of the European Union AND have been ordinarily resident within a Member State of the EU/Ireland for a continuous period of three out of the five years prior to the application deadline. 'Ordinarily resident' shall be deemed to refer to the applicant's place of legal and permanent residence. The 'ordinarily resident' period for EU citizens will not be deemed as having been interrupted if an absence from that residence has been caused by: training or employment of the applicant or the applicant's spouse or parents; the full-time education of the applicant or her/his spouse; an absence or absences for cultural or personal reasons. All other applicants should indicate that they are non-EU.

Once you have filled in all the requested details, click '**SUBMIT**'; the following screen will then be displayed:



An email from '**ircapps@research.ie**' with the subject '**Irish Research Council Registration Details**' will be automatically sent to the email address you have provided.

This email will:

- confirm that you have successfully registered as an applicant to the Irish Research Council Online Application System (OLS). You only need to do this once.
- issue you with a username and password.

If you do not receive this email:

- Please check your SPAM FOLDER; and if you have not already done so, add the ircapps@research.ie email address to your contacts/address book now.
- If you are using an institutional/work email account, the email may be blocked by the institution's firewall. Please contact your I.T. support to ask for the email to be released.

6.3 Using the OLS to create an application

Please note the following when using the system:

No alterations can be made to an application once it has been submitted. Therefore, it is important to check and re-check the application form until you are fully satisfied with all sections of your application before you click 'Submit Application'.

If you enter information into the OLS application form and **do not save** before navigating away from the tabbed page, this information will be lost.

Click on 'Application Overview' to navigate back to the start of the application form. **Do not** use the browser 'back' button at any stage as you may lose essential information.

All participants **must** complete their forms through the OLS. The Council will not be responsible for ensuring that participant online forms are submitted on time. It is the responsibility of the **Applicant** to ensure their application is submitted by the scheme deadline, 12:00 pm on 22nd December 2020. Applicants to Coalesce Research Fund may apply to more than one strand. Applying to more than one strand requires the applicant to create a new application per strand.

As detailed in the Terms and Conditions you should direct any queries about the scheme and application process to your Research Office. However, if you have a technical issue regarding the use of the OLS, please read these Guidelines and the FAQ document, both of which are available on our website www.research.ie. If your issue is not clarified through any of these mechanisms, only then should you email projects@research.ie with an outline of your query. Please include your Project ID, the browser you are using, and if appropriate, a screenshot of the OLS and any error messages.

6.4 To log in

Once you have received your username and password, access the OLS on the Irish Research Council website https://irishresearch.smartsimple.ie/s_Login.jsp

Please enter the username and password that were supplied to you in the 'Irish Research Council Registration Details' email and then click 'Log in'.

If you have misplaced your password use the '**Forget Your Password? – Please Click Here**' link on the login page (just under the login button). An email containing these details will be automatically sent to the email address you have supplied but it can take up to 15 minutes to receive.

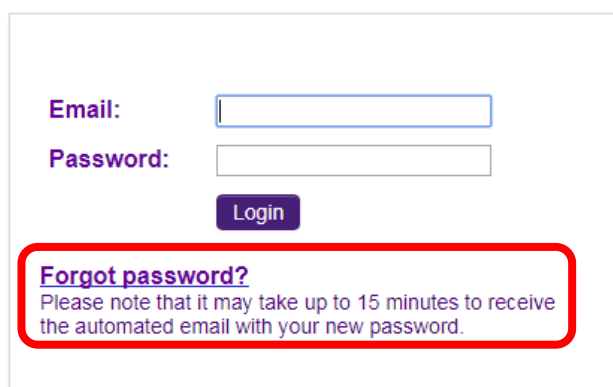

The screenshot shows a login form with two input fields: 'Email:' and 'Password:'. Below the 'Password:' field is a purple 'Login' button. At the bottom of the form, there is a red-bordered box containing the text 'Forgot password?' in blue, followed by 'Please note that it may take up to 15 minutes to receive the automated email with your new password.' in smaller blue text.

**Click here if you have
lost or misplaced your
password**

6.5 Creating a new Application

When you log in, you will be presented with the following 'Home' screen:

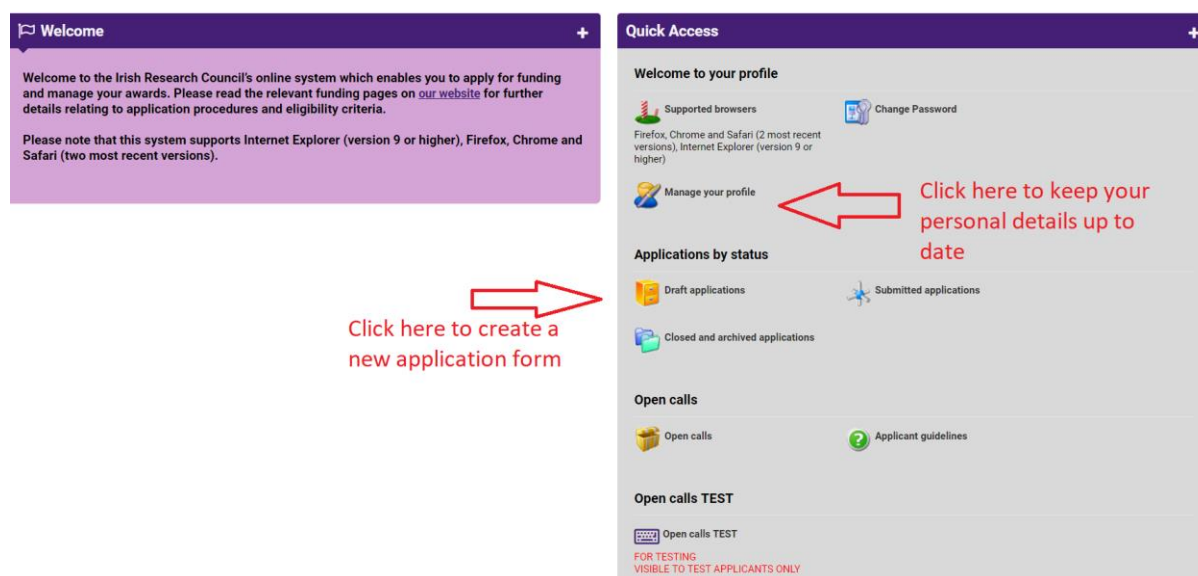

This is your 'Home Page' and you can access and edit your application prior to submission and prior to the Applicant deadline through this screen. If you want to change any of your personal details, you can click on the 'Manage your Profile' icon on this page.

- Select 'Open Calls'; you will be presented with the following screen:

Programme Name	Programme Status	Call Status	Applicant Submission Deadline Date	Participants Submission Deadline Date	Research Body Submission Deadline Date	Create Application
Government of Ireland Postdoctoral Fellowship	Active	Open	19/11/2020 16:00	26/11/2020 16:00	03/12/2020 16:00	You have already submitted an eligibility questionnaire
EPS Postdoctoral Application	Active	Open	02/12/2020 16:00	09/12/2020 16:00	16/12/2020 16:00	You have already created an Application for this Call. Please click your Draft Applications icon on your Portal.
EPS Postgraduate Application	Active	Open	02/12/2020 16:00	09/12/2020 16:00	16/12/2020 16:00	You have already created an Application for this Call. Please click your Draft Applications icon on your Portal.
COALESCE	Active	Open	22/12/2020 12:00		20/01/2021 16:00	Apply Click to apply

Select the appropriate Postdoctoral Application Type and then click 'Apply'.

Important System Note: If you enter information into the OLS application form and DO NOT SAVE before navigating away from the tabbed page, THIS INFORMATION WILL BE LOST! Also, you can click 'Application Overview' button on the application form to return to the summary page at the start of the application, but **DO NOT** use the browser back button at any stage as you may lose essential information.

In order to complete the application form, please answer the relevant questions in the 'Project – New Project' section.

At the beginning of the application select the Irish Research Body (i.e. [the Higher Education Institution 'HEI', or Research Performing Organisation, 'RPO'](#)) where you propose to be based for your project by selecting the 'Look up' button;

< OVERVIEW PROJECT DETAILS ETHICAL STATEMENT PROJECT BUDGET ACADEMIC QUALIFICATIONS ETHICAL TABLE AND SEX/GENDER STATEMENT >

Application type: Research for Policy and Society
 Status: Draft
 Create date: 28/10/2020 11:57:00
 Application deadline: 2020-12-22 12:00:00 Ireland time
 Project ID: COALESCE/2021/11

* Project title:
 ?
 98 words left

* Irish research body:
 ?

English translation: ?

Print form:
NEXT >

You will then be presented with the following screen:

Select Organisation

1-29 of 29 < >

Organisation Name	Address	City
<input type="radio"/> Athlone Institute of Technology	,	
<input type="radio"/> Cork Institute of Technology	,	
<input type="radio"/> Dublin City University	,	
<input type="radio"/> Dublin Institute for Advanced Studies	,	
<input type="radio"/> Dun Laoghaire Institute of Art, Design and Technology	,	
<input type="radio"/> Dundalk Institute of Technology	,	
<input type="radio"/> Economic and Social Research Institute	,	Dublin
<input type="radio"/> Galway-Mayo Institute of Technology	,	
<input type="radio"/> Institute of Technology, Carlow	,	
<input type="radio"/> Institute of Technology, Sligo	,	
<input type="radio"/> Institute of Technology, Tralee	,	
<input type="radio"/> Letterkenny Institute of Technology	,	

Select the check box next to the relevant institution name. If you cannot find your Institution name, please contact the Research Office (RO) of your [HEI/RPO](#) to make sure they are registered in the Irish Research Council OLS.

6.6 Editing a draft application

You may log on, access and edit your draft application as many times as you wish prior to the Applicant Deadline so long as the application has not been submitted and remains a 'Draft Application'. Edit your draft application by selecting the '**Draft Applications**' icon on your '**Home**' page. Then click on the 'Edit' button to the right of the screen.

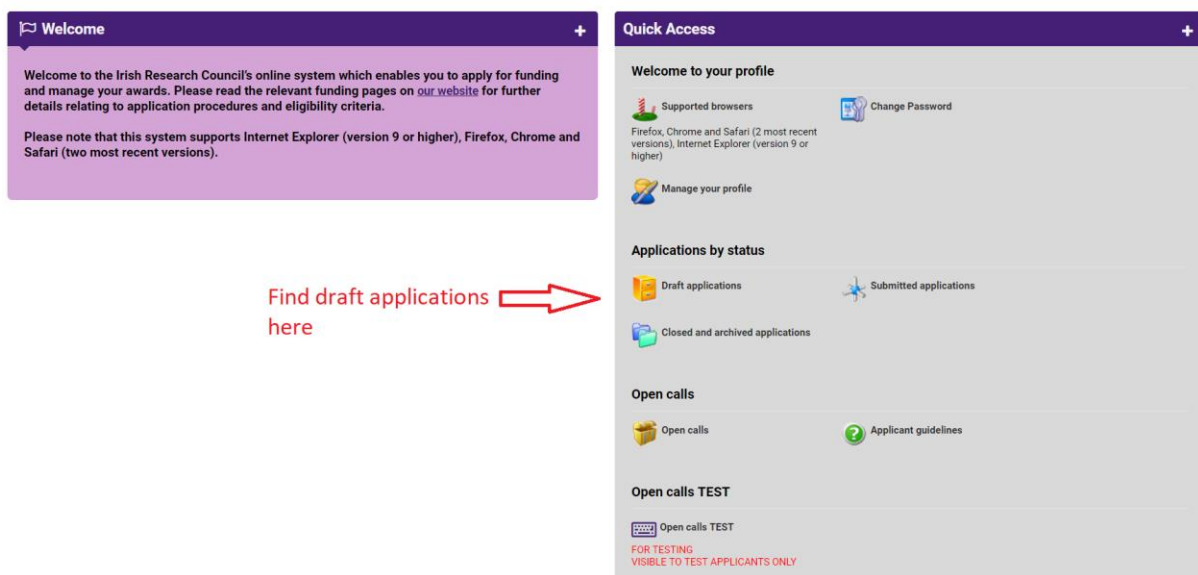

This will bring you to the top of the **'Application Overview'** page of your draft application. This page will already be in edit mode which will allow you to add information to your draft application.

PLEASE NOTE: There are two buttons at the bottom of the screen labelled 'Save Draft' and 'Submit Application'. Take caution when saving your draft that you do not accidentally submit an incomplete application.

6.7 Personal Details

Select whether your application is in Irish. You have the option to upload your own English translation. In order to do so you must first select 'Yes', then click 'Save Draft' at the bottom of the screen and then upload your document with the translation. The system will only accept documents in PDF format. If you do not wish to submit an English translation, then ignore the upload button that appears after you click 'Save Draft'.

The majority of details appearing in the 'Applicant Details' section lower down the page are populated based on the personal profile details entered when the Applicant registered at the beginning of this process.

Check that the 'Area where you are ordinarily resident (EU/non-EU)'.

OVERVIEW PROJECT DETAILS ETHICAL STATEMENT PROJECT BUDGET ACADEMIC QUALIFICATIONS ETHICAL TABLE AND SEX/GENDER STATEMENT APPLICANT DECLARATIONS

Applicant details

Name:	Fake Applicant 1
Email address:	ircfakeapplicant1@gmail.com
Please select the gender you identify with:	Female
Date of birth:	24/09/1986
Postcode:	Dublin 4
* What is your nationality, i.e. your passport-issuing country?:	Saint Helena

This section is automatically filled from your profile

Please provide the name of your passport-issuing country.

The above fields in the **Applicant Details** section are populated based on your personal profile. If you would like to update this section, please click **Save Draft** below and navigate back to the **Home** screen where you can find the **Manage Your Profile** icon.

* ORCID identifier:

666

* Do you currently hold, or have you previously held, an Irish Research Council Award? Note applicants in receipt of Council funding at the proposed start date of 1 March 2020 will be ineligible with the exception of a New Foundations grant, a Creative Connections grant and/or a Bluecoat award

ORCID is a persistent digital identifier that distinguishes you from every other researcher and, through integration in key research workflows such as manuscript and grant submission, supports automated linkages between you and your professional activities ensuring that your work is recognized. You can register for an ORCID here: <https://orcid.org/register>.

6.8 Managing your personal details

Please note if you want to change any of your pre-populated personal details, navigate to your Home Page by clicking 'Home' on the top right-hand corner of the screen.

IRISH RESEARCH COUNCIL
An Chomhairle um Thaighde in Éirinn

Welcome: Fake Applicant

Project - USA

Home Profile | Logout

Applicant Details

Name:	Fake Applicant2
Please select the gender you identify with:	Female
Date of birth:	01/01/1990
Postcode:	TEST
* What is your nationality, i.e. your passport-issuing country?:	

The above fields in the **Applicant Details** section are populated based on your personal profile. If you would like to update this section, please click **Save Draft** below and navigate back to the **Home** screen where you can find the **Manage Your Profile** icon.

* ORCID identifier:

Then click on the 'Manage your Profile' icon:

Welcome to your profile



Supported browsers
Firefox, Chrome and Safari (2 most recent versions), Internet Explorer (version 9 or higher)



Change Password



Manage your profile

6.9 Completing the application

To complete the application form, you will need to complete the following tabs:

- Overview
- Project Details
- Ethical Statement
- Project Budget
- Academic Qualifications
- Ethical Table and Sex/Gender Statement
- Applicant Declarations

Within each tab are sub-tabs which must be fully completed. There is helpful information available through pop-up boxes which appear when your cursor is hovered over particular questions.

* ORCID identifier:



Open "tool tips" by hovering over the question mark

* Do you currently hold, or have you ever held, a contract of sufficient duration with a Higher Education Institution? Please give details of the award

☐ Yes
 ☐ No

* Are you an academic or researcher who, on the call deadline of 22 December 2020, holds a contract of sufficient duration with a Higher Education Institution?

ORCID ID provides a persistent digital identifier that distinguishes you from every other researcher. If you do not currently have an ORCID ID, please register for one at www.orcid.org and provide us with your unique 16-digit identifier without hyphens.

6.10 Completing the Overview Tab

In the second 'Applicant details' section on the Overview tab, applicants should answer applicable Yes/No questions relating to their eligibility to this programme.

All applicants must confirm that the information supplied in this application is correct.

* Do you currently hold, or have you previously held, an Irish Research Council Award? Please give details of the award

☐ Yes
☐ No

* Please provide further details including the project end date

500 words left

* Are you an academic or researcher who, on the call deadline of 22 December 2020, holds a contract of sufficient duration with a Higher Education Institution or a recognised Research Performing Organisation (as defined in the 2020 Terms & Conditions) to carry out the proposed research from the project start date in Q3 2021 until the project end date?

☐ Yes
☒ No

Please note that you are **INELIGIBLE** to apply to this scheme. As per the 2020 Terms & Conditions, an applicant must on the call deadline, hold a contract of sufficient duration with a Higher Education Institution or a recognised Research Performing Organisation (as defined in the 2020 Terms & Conditions) to carry out the proposed research from the project start date, in Q3 2021, until the project end date.

Strand 2A and 2B Only: Does any identified co-PI, academic or researcher, on the call deadline of 22 December 2020, hold a contract of sufficient duration with a Higher Education Institution or a recognised Research Performing Organisation (as defined in the 2020 Terms & Conditions) to carry out the proposed research from the project start date, until the project end date?

☐ Yes
☒ No

Please note that you are **INELIGIBLE** to apply to this scheme. As per the 2020 Terms & Conditions, an Applicant and an identified co-PI must on the call deadline, hold a contract of sufficient duration with a Higher Education Institution or a recognised Research Performing Organisation (as defined in the 2020 Terms & Conditions) to carry out the proposed research from the project start date in Q3 2021 until the project end date.

* Strand 1K Only: Are you an academic or researcher who has at least two years' experience as a PI, experience of collaboration with research consortia and/or national research development projects and who has a track record in the research area of the DAFM strand?

☐ Yes
☒ No

Please note that you are **INELIGIBLE** to apply to this scheme. As per the 2020 Terms & Conditions, an Applicant to Strand 1K must on the call deadline, have at least two years' experience as a PI, experience of collaboration with research consortia and/or national research development projects and have a track record in the research area of the DAFM strand.

* Strand 2A Only: Is the identified co-PI on strand 2A a STEM academic or researcher who, on the call deadline, holds a contract of sufficient duration with a Higher Education Institution or a recognised Research Performing Organisation (as defined in the 2020 Terms & Conditions) to carry out the proposed research from the project start, until the project end date?

☐ Yes
☒ No

Please note that you are **INELIGIBLE** to apply to this scheme. As per the 2020 Terms & Conditions, an Applicant to Strand 2A must on the call deadline, be a STEM academic or researcher who holds a contract of sufficient duration with a Higher Education Institution or a recognised Research Performing Organisation (as defined in the 2020 Terms & Conditions) to carry out the proposed research from the project start, until the project end date.

Strand 2B Only: Are you an academic or researcher who has at least five years' experience as a PI, experience of collaboration with research consortia with an international focus and/or international research development projects and who has a track record in research under one or more of the DFA themes for this strand? Note: If the applicant is 3 years post-PhD and has won a New Foundations grant (DFA Strand), the applicant will be eligible. Applicants who are eligible under the latter caveat will need to demonstrate that they have the skills and experience to manage a project of this scale

☐ Yes
☒ No

Please note that you are **INELIGIBLE** to apply to this scheme. As per the 2020 Terms & Conditions, an applicant to strand 2B and an identified co-PI must on the call deadline, have at least five years' experience as a PI, experience of collaboration with research consortia with an international development focus and/or international research development project/s with a track record in research under one or more of the DFA themes for the strand.

Strand 2B Only: Is the co-PI an academic or researcher who has at least three years' experience as a PI, experience of collaboration with research consortia with an international development focus and/or international research development project/s and who has a track record in research under one or more of the DFA themes for this strand?

☐ Yes
☒ No

Please note that you are **INELIGIBLE** to apply to this scheme. As per the 2020 Terms & Conditions, an Applicant to Strand 2B and an identified co-PI must on the call deadline, have at least three years' experience as a PI, experience of collaboration with research consortia with an international development focus and/or international research development projects and a track record in research under one or more of the DFA themes for the strand.

* Please specify your PhD graduation date.

Note 1: As per the 2020 Terms & Conditions, applicants must hold a doctoral degree which was awarded no later than 31 May 2019 for applicants to Strands 1K and Strand 2A, and no later than 31 May 2016 for applicants to Strand 2B.
Note 2: For Strand 2B, if the applicant is 3 years post-PhD and has won a New Foundations grant (DFA Strand), the applicant will be eligible. Applicants who are eligible under the latter caveat will need to demonstrate that they have the skills and experience to manage a project of this scale.
For the purposes of this condition, a certified copy of the PhD graduation certificate will be taken into account and will be required upon conditional offer of award.
If you have not yet graduated, YOU MUST have all the requirements for the award of a doctoral degree, including the submission of the hardbound corrected thesis within the required timeline. Please indicate the year of submission below.

dd/mm/yyyy

* Employment status

☐ Permanent
☐ Indefinite duration
☐ Fixed term contract
☐ Not currently employed

* Have you informed the Research Office in the (proposed) host institution of your intention to submit an application to this programme?

☐ Yes
☒ No

Applicants must inform the Research Office of their intent to submit an application to this programme.

Save Draft

6.11 Completing the Project Details Tab

All applicants must indicate which funding strand to which they are applying.

Please note: Applicants to Strand 2B planning to make an application to FP9 (Horizon Europe) should include this intention in the project description.

It is the applicant's responsibility to ensure that prospective proposals will contribute to the current evidence base and that the proposals do not duplicate current evidence.

All applicants must select a proposed award duration in number of months. Ensure that your choice is in line with the maximum project durations in the Terms & Conditions for your chosen strand.

All applicants must select the primary area, discipline, and other research area that relates to their proposal.

* Please select the appropriate funding strand for which you are applying

?

* Proposed award duration in number of months

?

Please consult the Irish Research Council's [Annex A](#) and [Annex B](#) for a description of what is covered in Primary Areas, Disciplines and Other Research Areas:

* Primary Area: ?

Other Research Area:

* Keywords describing proposed research (<10 words)

10 words left

* Abstract. Please provide a short description of the proposed research project.

← Abstract

300 words left

* Lay Abstract. Please provide a short description of the proposed research project for a non-expert reader (300 words)

← Lay Abstract

300 words left

* For 1K, outline the added value collaboration with the Strategic Funding Partner for this strand will bring to the project and the associated policy area. For 2A, outline of the value that collaboration with the STEM Co-PI on this strand will bring to the project. For 2B, outline of the value collaboration with the Strategic Funding Partner on this strand will bring to the project.

← Outline of the value collaboration accordingly to strand

200 words left

All applicants must provide a short description of their proposed research project.



All applicants must provide a short description of their proposed research project for a non-expert reader.

All applicants must also provide an outline of the value collaboration. For 1K, outline the added value collaboration with the Strategic Funding Partner for this strand will bring to the project and the associated policy area. For 2A, outline of the value that collaboration with the STEM Co-PI on this strand will bring to the project. For 2B, outline of the value collaboration with the Strategic Funding Partner on this strand will bring to the project.

OVERVIEW **PROJECT DETAILS** ETHICAL STATEMENT PROJECT BUDGET ACADEMIC QUALIFICATIONS ETHICAL TABLE AND SEX/GENDER STATEMENT APPLICANT DECLARATIONS

	<ul style="list-style-type: none"> • Provide comprehensive details of the proposed approach including the research methodology. • Demonstrate how the applicant's experience and expertise is relevant to the proposed project including a demonstration of a proven ability to carry out the work in an impartial and objective manner. • Identify and elaborate on the potential of the proposed research for further capacity-building (for example consortia building on interdisciplinary projects). • Provide evidence of the integration of cross-sectoral collaboration including coherence and credibility of collaboration including on innovative aspects of the project. Outline the proposed management of the project and contingency plan. • Specific milestones of project management should be included in the Research Schedule section which may be supported with a Gantt chart.
Strand 2B :	<ul style="list-style-type: none"> • Suitability of the proposal's concept in relation to the intention of the scheme. • Identify and elaborate on significance and contribution of the proposed project to the chosen Irish Aid thematic focus. • Provide comprehensive details of the proposed approach including the research methodology. • Provide evidence of the potential for the project to support enhanced research capacity in partner countries. • Demonstrate the project's potential to enhance global north-south partnership targeting future applications to international funding opportunities. • Provide evidence of cross-sectoral policy or civil society partnerships. Outline the proposed management of the project and contingency plan. • Specific milestones of project management should be included in the Research Schedule section which may be supported with a Gantt chart.
Outputs and Impact :	<ul style="list-style-type: none"> • The potential impact of the proposed research project on the individual/team/research programme, including the potential for further research activity, the alignment with identified SDG/s and the Institutional/organisational research and teaching strategy. • The possible impact on the teaching programme, including courses taught and students supervised or the potential impact on the development of capability in the Host Organisation. • Plans for dissemination and knowledge exchange activities. In particular, the direct outputs envisaged, evidence of collaboration and impact on policy in the relevant area. • Applicant(s)' research and other expertise relevant to the project proposal. • Research achievements including current and previous research awards. • Key Outputs including Publications (e.g. published reports, creation of data sets & databases, exhibitions, etc.) • Evidence of previous evidence-based policy research.

* Detailed Project Description Upload

   Click button to upload PDF file

* List of Research Projects for which Principal Investigator is currently involved in or has responsibility for (include details of the project title, the source of award, the funding amount and the award duration)

A 'Detailed Project Description' must be uploaded by all applicants. It can be uploaded in pdf only and cannot exceed 14 pages. **At least two of the 14 pages should be dedicated to providing a detailed description of methods and analysis to be used in the proposed project.** Methods and analysis should be clearly mapped onto overall objectives and proposed research question(s).

Further details including a information regarding the identification of a 'Steering Group or Advisory Committee', a 'Research Schedule' and a 'Data Management Plan' must also be provided in the 'Project Details' section.

Applicants should outline the step by step plan of action for their project, demonstrating how the stated research questions will be answered. This includes details of the project's location in existing literature, the methodology(ies) to be used, detailed implementation and dissemination plans, major project milestones and how intended project outputs and impact will be achieved.

Per Section 5.1 of the Terms & Conditions, the Data Management Plan must describe the data management life cycle for the data to be collected, processed and/or generated by a research project. As part of making research data *findable, accessible, interoperable and re-usable* (FAIR). See the Terms & Conditions for further details.

6.12 Completing the Ethical Statement

Ethics Statement

Where ethical issues may arise in the research, applicants are required to submit to the Council a written statement that full consideration has been given to the ethical implication of the research proposal. Full ethical approval from the relevant HEI Ethics Committee is not required at the application stage. However, if the application is successful, evidence of full ethical approval will be required as part of the Award Acceptance (as per the 2020 [Terms & Conditions](#)).

OVERVIEW PROJECT DETAILS **ETHICAL STATEMENT** PROJECT BUDGET ACADEMIC QUALIFICATIONS ETHICAL TABLE AND SEX/GENDER STATEMENT APPLICANT DECLARATIONS

Ethical Statement

Please read carefully the section on Research Ethics in the Terms and Conditions.

* Does the research proposal outlined in this submission require approval by the relevant University/Institutional Ethics committee?

☒ Yes
☐ No

* If funded, any ethical issues relating to your proposed research programme will be subject to the rules and regulations of your Irish Host organisation. You must agree to abide by these rules and regulations, including any full ethical review which it requests prior to embarking on your research programme.

☒ I Agree to abide by the ethical rules and regulations of my proposed Host Organisation

[< BACK](#) [NEXT >](#)

[Save Draft](#) [Submit Application](#)

6.13 Project Budget

All applicants must upload a detailed, itemised project budget with justification for the costs requested.

OVERVIEW PROJECT DETAILS ETHICAL STATEMENT **PROJECT BUDGET** ACADEMIC QUALIFICATIONS ETHICAL TABLE AND SEX/GE >

Budget: [Open Budget](#)  Click this button to open the budget entry window

Eligible Costs:	Total cost requested for the full duration of the award:	Justification. Please provide itemised breakdown of costs and reason needed (justification fields cannot be left blank. Enter 'n/a' if necessary):
Personnel/Staff:		
Collaboration:		
Dissemination and Knowledge Exchange:		
Travel Costs:		

[< BACK](#) [Next: Maximum Standard 1K](#) [NEXT >](#)

[Save Draft](#) [Submit Application](#)

Click button labelled 'Open Budget' to open itemised budget entry window.

Budget Details for COALESCE/2021/15

Eligible Costs:	Total cost requested for the full duration of the award:	Justification. Please provide itemised breakdown of costs and reason needed (justification fields cannot be left blank. Enter 'n/a' if necessary):
* Personnel/Staff:	<input type="text" value="0"/>	<input type="text"/>
* Collaboration:	<input type="text" value="0"/>	<input type="text"/>
* Dissemination and Knowledge Exchange:	<input type="text" value="0"/>	<input type="text"/>
* Travel Costs:	<input type="text" value="0"/>	<input type="text"/>
* Consumables: Maximum €1,000 on Strand 1K; Maximum €2,000 on Strand 2A; Maximum €5,000 on Strand 2B	<input type="text" value="0"/>	<input type="text"/>
* Consultancy: Maximum €5000 on Strands 1K; and €10,000 on Strand 2A and 2B	<input type="text" value="0"/>	<input type="text"/>
* Publications and Research Outputs:	<input type="text" value="0"/>	<input type="text"/>
* Access to Research Infrastructure:	<input type="text" value="0"/>	<input type="text"/>

The bottom of this window also has advisory notes on staff costs and staffing requirements.

Advisory Note on Staff Costs Staffing Requirements

Costs may include staff-replacement costs which facilitate participation in the project, but **these must be clearly justified. All staff replacements ('buy-out' costs) must be accounted for** according to approved Irish Research Council staff rates.

IRC Staff Costs	1 Calendar Year	1/2 Calendar Year
Academic Replacements	€24,817 (inclusive of PRSI Employer Pension Contribution)	€12,409 (inclusive of PRSI Employer Pension Contribution)
Research Assistant (can be pro-rata)	HEIs should use the institutional researcher salary scale for research assistants and postdoctoral researchers. These costs must be clearly justified in the application form. The salary requested must include provisions for PRSI Employer Pension Contribution. As part of the award acceptance process, the research office must confirm that the requested salary is line with the institutional researcher salary scale and provide documentary evidence.	
Postdoctoral Researcher (can be pro-rata)	HEIs can use their own institutional researcher salary scale for research assistants and postdoctoral researchers. These costs must be clearly justified in the application form. The salary requested must include provisions for PRSI Employer Pension Contribution%. As part of the award acceptance process, the research office must confirm that the requested salary is line with the institutional researcher salary scale and provide documentary evidence.	

The recruitment of any staff to this project must be openly recruited through public advertisement. Staff must be recruited for the specific project and awarded topic only.

The only exception to this is the STEM Co-PI on strand 2A applications; due to being a named participant on the project, this post need not be advertised publicly.

Other Eligible Research Expenses

Please note that all research expenses must be strongly justified. Should a particular expense be insufficiently justified within an otherwise successful application, the Council reserves the right to remove/reduce this particular expense item at award-offer stage.

A table of other eligible research expenses are set out below:

Expense Type	Eligibility Criteria
Collaboration	Please provide details of expenditure to be incurred in terms of collaborative activities, where relevant. These will primarily consist of travel, networking and/or dissemination activities and must be strongly demonstrated. Maximum of 10% of the overall budget
Dissemination	Details of costs proposed and channels to be used.
Travel Costs	Travel and accommodation costs may be included as part of the proposal. Details on the number and duration of trips being proposed are required. Every effort must be made to ensure that travel expenses are minimised (e.g. economy fares only).
Consumables	Maximum €1,000 on Strand 1K; Maximum €2,000 on Strand 2A; Maximum €5,000 on Strand 2B.

When finished entering your budgetary information, ensure that you click 'Save' **before** clicking 'Close' at the bottom of the window.

Expense Type	Eligibility Criteria
Collaboration	Please provide details of expenditure to be incurred in terms of collaborative activities, where relevant. These will primarily consist of travel, networking and/or dissemination activities and must be strongly demonstrated. Maximum of 10% of the overall budget
Dissemination	Details of costs proposed and channels to be used.
Travel Costs	Travel and accommodation costs may be included as part of the proposal. Details on the number and duration of trips being proposed are required. Every effort must be made to ensure that travel expenses are minimised (e.g. economy fares only).
Consumables	Maximum €1,000 on Strand 1K; Maximum €2,000 on Strand 2A; Maximum €5,000 on Strand 2B.
Consultancy	Maximum €5,000 on Strand 1K; Maximum €10,000 on Strand 2A; Maximum €10,000 on Strand 2B.
Overheads	These must NOT exceed maximum of 25% of modified direct costs. Overhead does not apply to equipment costs
Equipment	Please provide details and justification for any items of equipment being sought. Computer equipment, fieldwork, data collection, archival and digitisation costs may be included under this heading. The Council will pay particular attention to any equipment sought (e.g. laptops, tablets, scientific tools etc.). Any such requests will require a strong rationale and an account of why such items might not be available to an applicant from any other source.

Click SAVE before closing the window → Save Clear Close ← **After clicking SAVE, click close**

6.14 Academic Qualifications

All applicants must provide details of their academic qualifications. Successful applicants will be required to provide official transcripts/parchments before awards are confirmed.

All applicants must also provide additional information regarding relevant research achievements since beginning a career as a researcher (since you completed the degree that qualifies you to embark on doctoral studies in Ireland or in the country of the proposed secondment/placement).

[OVERVIEW](#) | [PROJECT DETAILS](#) | [ETHICAL STATEMENT](#) | [PROJECT BUDGET](#) | **[ACADEMIC QUALIFICATIONS](#)** | [ETHICAL TABLE AND SEX/GENDER STATEMENT](#) | [APPLICANT DECLARATIONS](#)

Doctoral Degree

Or degree equivalent to the Doctoral Degree level 10 on the Irish National Framework of Qualifications NFQ, see <http://www.nfq.gov/index.htm>

* Qualification Type and Name:

* Institution:

* Country: — Select One —

* Supervisor:

* Doctoral thesis title:

* Abstract:

300 words left

* Has your doctorate been awarded?

☐ Yes

☒ No

If no, you do not meet the eligibility requirements for the strand to which you are applying and any submitted application will be ineligible

* Select yes if you comply with ALL of the above eligibility requirements

Note: It is important to provide accurate information at this point. Should your application be recommended for funding you will be asked to provide evidence that your viva/thesis defence took place before the stated date in the terms and conditions. Should it subsequently emerge that the information provided was inaccurate at the submission deadline, the application will be withdrawn from the process.

☒ Yes

☐ No

Other Education

Please provide any additional information relevant to your academic background which should include the name, location and dates for each relevant course listed. For major awards provide also equivalency of the degree to the [Irish National Framework of Qualifications](#).

300 words left

Research Achievements

Please provide any additional information regarding your relevant research achievements since beginning a career as researcher (since you completed the degree that qualifies you to embark on doctoral studies in Ireland or in the country of the proposed secondment/placement).

300 words left

[< BACK](#) | [NEXT >](#)

Sex/Gender Dimension Statement

All applicants to Council schemes are required to complete the Sex/Gender Dimension statement in the application. This is also a requirement for Horizon 2020 proposals. Please refer to Appendix 5 'Guidance on the Sex/Gender Dimension Statement' of the 2020 COALESCE Terms and Conditions, which summarises the Toolkit Gender in EU-funded research¹, for help on how to do this.

OVERVIEWPROJECT DETAILSETHICAL STATEMENTPROJECT BUDGETACADEMIC QUALIFICATIONS

ETHICAL TABLE AND SEX/GENDER STATEMENTAPPLICANT DECLARATIONS

Sex / Gender Dimension Statement

Please read carefully Appendix 1 - Sex/Gender Dimension in the Terms & Conditions for help in answering this question.

Does your proposed research programme involve any of the following?

1. Humans as the research focus.

2. Animals as the research focus.

3. Human samples and/or data.

4. Humans involved as consumers, users, patients, or in trials.

5. Research on animals, animal samples and/or data.

6. Research outputs with implications for end users or consumers.

If your proposed research programme involves one of the above, note that your proposed research may have a potential biological sex or social gender dimension.

☒ Yes

☐ No

* If you have answered NO to the questions above, please explain why there is no potential biological sex and/or gender dimension to be considered in your proposed research. If you have answered YES to the questions above, indicate how potential biological sex and/or gender issues will be handled. In particular, you are asked to reference the points mentioned in the 'Checklist for sex/gender in research content' in the Irish Research Council's Terms and Conditions.

BACK

NEXT

6.16 Applicant Declarations and Submission

All applicants must answer the questions on this tab and confirm that all information provided is accurate before submission.

OVERVIEWPROJECT DETAILSETHICAL STATEMENTPROJECT BUDGETACADEMIC QUALIFICATIONS

ETHICAL TABLE AND SEX/GENDER STATEMENTAPPLICANT DECLARATIONS

* Would you like the Irish Research Council to make your application available to other Funding Agencies and/or Enterprise Partners for funding consideration?

☒ Yes

☐ No

* I hereby declare that I have read and accept the Applicant requirements as set out in the Terms and Conditions on the Irish Research Council [WEBSITE](#)

☒ I Agree

* I confirm that the information supplied in this application is correct (NOTE: Should it become apparent that any of the information provided in the application is inaccurate or is not verifiable with appropriate documentation, it will result in the application automatically being deemed ineligible)

☒ I Agree

BACK

Save DraftSubmit Application

Once you have completed this page, click 'Save Draft'. From this point, you will be able to navigate back and edit other sections of the application, return to your application at a later point, or submit your application by clicking 'Submit Application'. **Please note, once you submit your application, you will no longer be able to edit it or upload documents.**

¹http://www.yellowwindow.be/genderinresearch/downloads/YW2009_GenderToolKit_Module1.pdf

7 Assessment Process

Applications deemed eligible by the Council will be assigned to international remote reviewers. Those found ineligible will not proceed to the assessment phase. When all remote reviewers are complete a short list of applications will be compiled. These applications will pass into the next phase of assessment. An international panel will assess the shortlisted applications. For more in-depth information, please refer to Appendix 4 'Evaluation Procedures and Criteria' of the Terms and Conditions.

Applicants may check the status of their application by logging onto the OLS.

8 Notification and feedback

Once the assessment process is complete, applicants will be informed of the outcome by email and their status will be updated on the OLS. The Executive are precluded from discussing the results of the competition over the telephone or discussing the outcome of individual applications via email or post. Feedback to candidates will consist of the score that the IAB assigned the application and the decision of the Council in relation to funding. Additional feedback will not be provided beyond that which is provided with the assessment result.

Please note that this decision is final and that no correspondence will be undertaken in relation to individual assessments or scoring. Under no circumstance will feedback provided by Council compromise the confidentiality of a reference submitted to Council.

9 Information for successful award holders

Once recommended for funding, successful applications will appear in the OLS as 'conditional'. The Council will issue a Letter of Offer and an Acceptance Form outlining the approved budget for the Award to the successful applicants. Each award is made subject to the terms of the Letter of Offer, the application, the approved budget, and the Terms and Conditions for this Scheme.

The conditional offer is subject to the Acceptance Form being signed by the successful award holder, the HEI, and returned to the Council on time. It is also subject to any other required documentation (e.g. academic transcripts) being supplied to the Council in a timely fashion.

9.1 Submission of Ethical Approval, a Data Management Plan and a Research Agreement

If successful in the competition, a full ethical report and approval from an ethical review committee will need to be received by the Council within six months of the start date. As ethical review committees only meet sporadically each year, it is recommended that applicants start thinking about this process early.

A detailed Data Management Plan (DMP) will need to be submitted with the first progress report at six months after the commencement of the project. The DMP should describe the data management life cycle for the data to be collected, processed and/or generated by a research project. As part of making research data findable, accessible, interoperable, and re-usable (FAIR), a DMP should include information on:

- the handling of research data during and after the end of the project;
- what data will be collected, processed and/or generated;
- which methodology and standards will be applied;
- whether data will be shared/made open access. If data cannot be made available, explain why;
- how data will be curated and preserved (including after the end of the project).

For further information and advice concerning DMPs, see sections 5.1: Data management plans and Appendix 7 of the COALESCE 2020 Terms & Conditions.

Where more than one institution is involved in an award, a Research Agreement must be submitted before the award can commence.

10 Guidance on the Sex/Gender Dimension Statement

While there are research projects in which biological sex and/or gender may not be relevant in terms of the research content, it is well established that, where relevant, not integrating sex and gender analysis into the design, implementation, evaluation and dissemination of the research can lead to poor results and missed opportunities.

The following is provided to help applicants complete the sex/gender dimension statement in the application. This is taken from the Toolkit Gender in EU-funded research², which aims to give the research community practical tools to integrate gender aspects into their research, including gender equality (equal outcomes for women and men) and integration of sex/gender analysis in research content. Please also refer to <http://genderedinnovations.stanford.edu/> for examples of case studies in Science, Health and Medicine, Engineering and Environment.

10.1 A Summary from the 'Toolkit Gender in EU-funded research'

The best possible research validity: Research should take into account the differences between men and women in the research population, the results will be more representative. General categories such as 'people', 'patients' or 'users' do not distinguish between men and women. Research based on such categories may well draw partial conclusions based on partial data. For example, research on a new breast cancer treatment should include male patients, so as to draw a complete picture. Most basic research with animal models focuses on males to the exclusion of females (Zucker et al., 2010; Marts et al., 2004). Research on economic migrants cannot limit itself to male points of view if it wants to understand the whole migrant population.

Research ideas and hypotheses: The relevance of biological sex and/or gender for and within the subject matter needs to be analysed and an assessment made as to whether these are relevant variables. The formulation of hypotheses can draw upon previous research and existing literature. Indeed, the body of knowledge on sex/gender issues has been steadily growing over recent decades and can serve as interesting reference material to build new hypotheses for future research.

Project design and research methodology: While research methodologies may vary, they all strive to represent (aspects of) reality. Whenever this reality concerns humans, any sound methodology should differentiate between the sexes and take into account the men's and women's situations equally.

² http://www.yellowwindow.be/genderinresearch/downloads/YW2009_GenderToolKit_Module1.pdf

Groups such as 'citizens', 'patients', 'consumers', 'victims' or 'children' are therefore too general as categories.

Research implementation

Data collection tools (such as questionnaires and interview checklists) need to be gender-sensitive, use gender neutral language, and should make it possible to detect the different realities of men and women. This will help to avoid gender bias. For example, answers to be provided by the 'head of household' are not necessarily valid for all household members.

Data analysis: In most research concerning human subjects, data is routinely disaggregated by sex, which would logically lead to analyses according to sex. However, to date, this is still not common practice. Systematically taking sex as a central variable and analysing other variables with respect to it (e.g. sex and age, sex and income, sex and mobility, sex and labour) will provide significant and useful insights. Involving gender-balanced end-user groups in the course of the research is also a good way of guaranteeing the highest impact.

Dissemination phase – reporting of data: Collecting and analysing sex and/or gender specific data is not enough if they are omitted from the published results. Sex and/or gender should be included in 'mainstream' publications as it is as much part of daily reality as any other variable studied. Specific dissemination actions (publications or events) for sex and/or gender findings can be considered. Institutions and departments that focus on gender should be included in the target groups for dissemination. Publications should use gender-neutral language.

10.2 Checklist for Sex and/or Gender in Research content

Research ideas phase:

- o If the research involves humans as research objects, has the relevance of biological sex and/or gender to the research topic been analysed?
- o If the research does not directly involve humans, are the possibly differentiated relations of men and women to the research subject sufficiently clear?
- o Have you reviewed literature and other sources relating to differences in the research field?

Proposal phase:

- o Does the methodology ensure that (possible) sex/gender differences will be investigated: that sex/gender differentiated data will be collected and analysed throughout the research cycle and will be part of the final publication?
- o Does the proposal explicitly and comprehensively explain how sex/gender issues will be handled (e.g. in a specific work package)?
- o Have possibly differentiated outcomes and impacts of the research on women and men been considered?

Research phase:

- o Are questionnaires, surveys, focus groups, etc. designed to unravel potentially relevant sex and/or gender differences in your data?

- o Are the groups involved in the project (e.g. samples, testing groups) gender-balanced? Is data analysed according to the sex variable? Are other relevant variables analysed with respect to sex?

Dissemination phase:

- o Do analyses present statistics, tables, figures, and descriptions that focus on the relevant sex/gender differences that came up in the course of the project?
- o Are institutions, departments and journals that focus on gender included among the target groups for dissemination, along with mainstream research magazines?
- o Have you considered a specific publication or event on sex/gender-related findings?